

## Silo

### Wall Sconce

The rippled form and glass sphere casts a soft diffused glow, providing a gentle and glare free light source perfect for residential and commercial interiors.

Technical Details	
Dimensions	Ø135 x 95mm (incl. bulb)
Material	Hardwood, Glass
LED	Cree Integral LED
Bulb	ø80mm Matte Opal Glass Sphere
Input Voltage	6V via 240V remote driver
CRI	90
Wattage	2W
Lumens	450lm approx.
Colour Temperature	2700K 3000K
Dimming	Phase-cut, DALI other dimming types on request
Warranty	3 Years



Create a Custom Sconce		
Design	Silo Timber Sconce	
Timber	Walnut	WA
	Rock Maple	MA
	American Oak	AO
	American Oak - Black Finish	AOB
	American Oak - White Oil Finish	AOO
	Tasmanian Blackwood	TB
	Tasmanian Oak	TO
	Spotted Gum	SG
	Custom Tint Colour	TINT
	Wall Plate Finish	Black
White		WH
LED Colour Temperature	2700K	27K
	3000K	3K

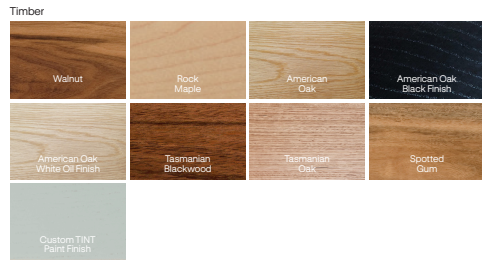

#### Dimensions

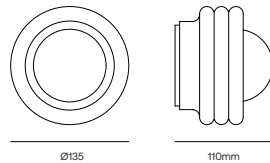

Ø135

110mm

## Silo

### Wall Sconce

#### Installation Details

1. Prep the wall with a (minimum) 40mm hole.
2. Screw the wall plate onto the wall with the appropriate fasteners for the wall material.
3. Terminate cables appropriately. The transformer needs to be accessible for maintenance purposes.
4. Mount the timber body to the wall plate using the attached bracket. Secure the two brackets together using the M3 grub screw. (A suitable hex key is supplied)
5. Test installation meets the requirements of AS/NZS 3000.

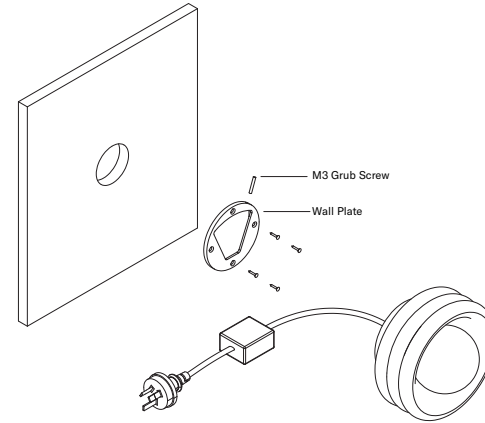

#### Wall Plate Details

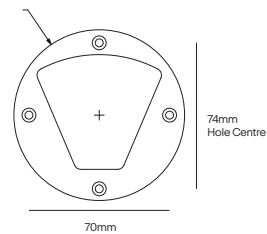

70mm

74mm  
Hole Centre

#### Driver Details

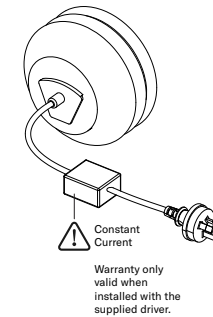

Warranty only valid when installed with the supplied driver.