

Button

Wall Sconce

A cute though versatile solid hardwood and glass sconce well suited to small reading nooks, lounge rooms, hallways and bedrooms.

The integral LED lightsource is a maintenance free lighting option for restaurants, cafes, offices and commercial spaces.

Technical Details	
Dimensions	Ø122 x 117mm
Material	Solid Timber, Glass, Aluminium
LED	Cree Integral LED
Bulb	ø100mm Matte Opal Glass Sphere
Input Voltage	6V via 240V remote driver
CRI	90
Wattage	2W
Lumens	450lm approx.
Colour Temperature	2700K 3000K
Dimming	Phase-cut, DALI Other dimming types on request
Warranty	3 Years



Create a Custom Sconce

Design	Button Sconce	BU
Timber	Walnut	WA
	Rock Maple	MA
	American Oak	AO
	American Oak - Black Finish	AOB
	American Oak - White Oil Finish	AOO
	Tasmanian Blackwood	TB
	Tasmanian Oak	TO
	Spotted Gum	SG
	Custom Tint Colour	TINT
	Wall Plate Colour	Black
White		WH
Gold Pearl		GP
Pale Bronze		PB
Medium Bronze		MB
Aged Brass		AB
LED Colour Temperature	2700K	27K
	3000K	3K

Timber

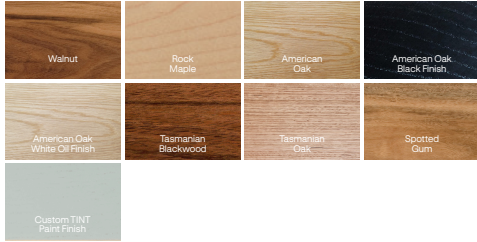

Dimensions

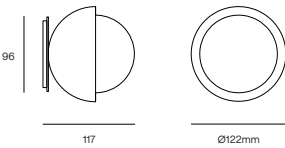

Button

Wall Sconce

Wall Plate Details

1. Prep the wall with a (minimum) 40mm hole.
2. Screw the wall plate onto the wall with the appropriate fasteners for the wall material.
3. Terminate cables appropriately. The transformer needs to be accessible for maintenance purposes.
4. Mount the timber body to the wall plate using the attached bracket. Secure the two brackets together using the M3 grub screw. (A suitable hex key is supplied)
5. Test installation meets the requirements of AS/NZS 3000.

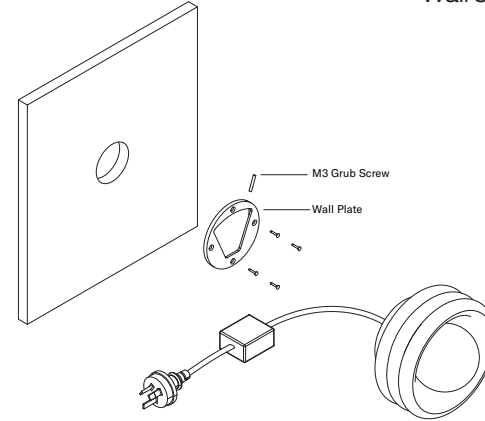

Wall Plate Details

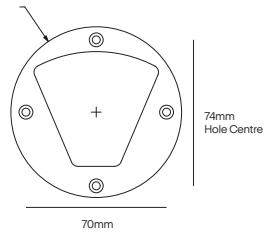

Driver Details

